

**AXIS**<sup>®</sup>  
RV BY THOR MOTOR COACH



**THOR**<sup>®</sup>  
MOTOR COACH

Made to fit.

# Floor Plans

24.1

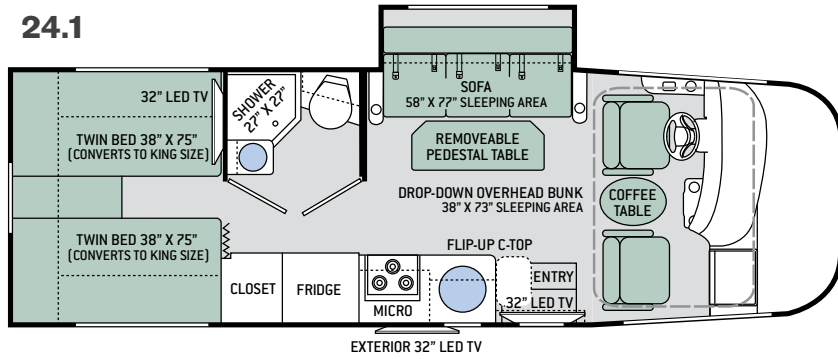

25.4

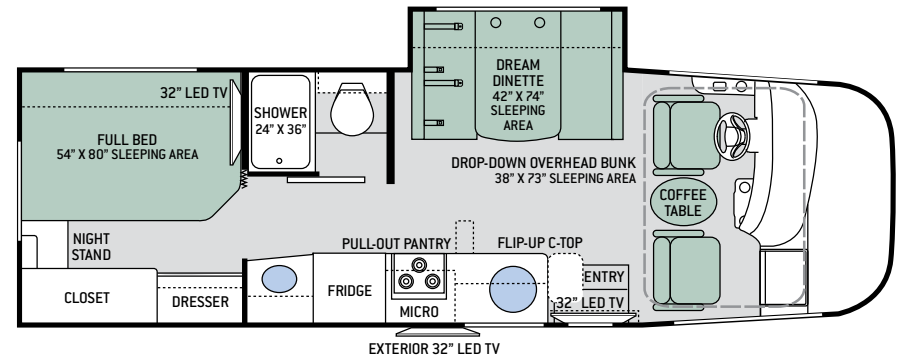

25.2

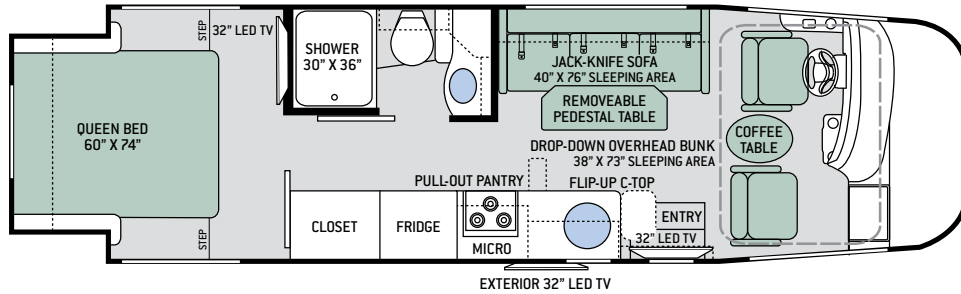

25.5

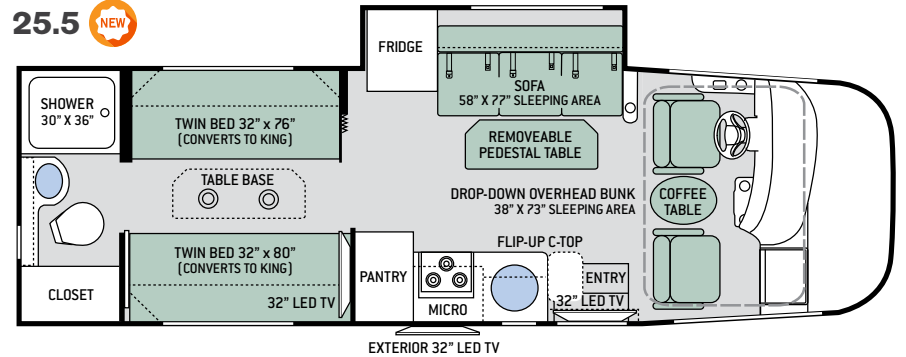

25.3

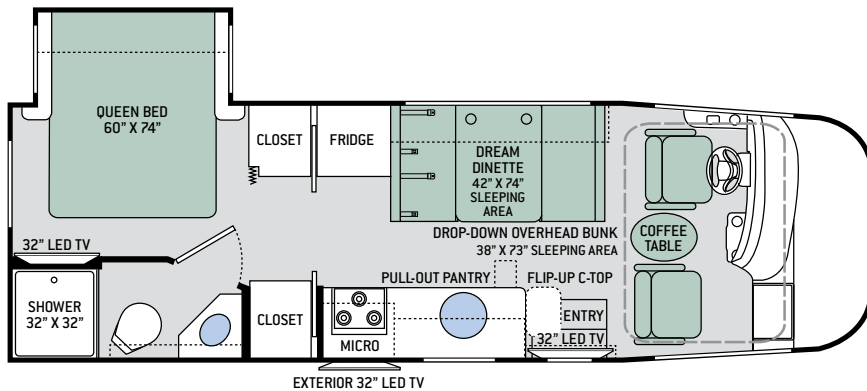

## Specifications

	24.1	25.2	25.3	25.4	25.5
Chassis	Ford	Ford	Ford	Ford	Ford
Gross Vehicle (GVWR)	12,500	12,500	12,500	12,500	12,500
Gross Combined (GCWR)	18,500	18,500	18,500	18,500	18,500
Wheel Base	188"	194"	188"	188"	188"
Exterior Length (w/o ladder)	25'-6"	26'-6"	26'-6"	27'	27'
Exterior Height (w/ AC)	11'-3"	11'-3"	11'-3"	11'-3"	11'-3"
Exterior Width (w/o mirrors)	94"	94"	94"	94"	94"
Interior Height (living area)	82"	82"	82"	82"	82"
Awning Size	16'-5"	18'	18'	18'	18'
Fuel (gal)	55	55	55	55	55
LPG (lbs)	40.9	40.9	40.9	40.9	40.9
Fresh/Waste/Gray Water (gal)	42 / 30 / 40	39 / 30 / 40	50 / 30 / 41	42 / 30 / 40	42 / 41 / 30
Water Heater (gal)	Instant Tankless	Instant Tankless	Instant Tankless	Instant Tankless	Instant Tankless
Furnace (BTUs)	30,000	30,000	30,000	30,000	30,000
Exterior Storage Capacity (cu. ft.)	63.5	47	40	70	38.2



# Interior Decor



HARBOR SHORES



COUNTERTOPS



RESIDENTIAL VINYL FLOORING



WHISPER DUNE II



BRAZILIAN CHERRY

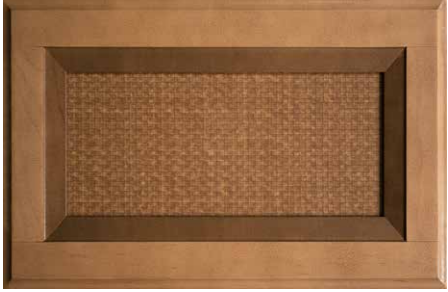

SYDNEY MAPLE

# Exterior Graphics



VANILLA ICE 



WINDJAMMER 

# Features

## CONSTRUCTION & EXTERIOR

- Ford® E-Series Chassis – 6.8L Triton® V10 Engine, 305HP, 420 lb.-ft. Torque – TorqShift® 6-Speed Automatic with Overdrive Transmission
- Welded Tubular Steel Floor System
- Welded Tubular Aluminum Roof & Sidewall Cage Construction
- Vacu-Bond Laminated Roof, Walls & Floors with Block Foam Insulation
- Premium One-Piece TPO Roof
- One-Piece Fiberglass Front Cap
- HD-MAX® Exterior with Graphics Package
- Rotocast Storage Compartments
- Flush Mount Radius Compartment Doors
- Power Patio Awning with Integrated LED Lighting
- Slideout Room Topper Awning
- Roof Ladder (24.1, 25.3, 25.4 & 25.5)
- Patio Light
- Frameless Windows
- 8,000-lb. Trailer Hitch

## AUTOMOTIVE & COCKPIT

- Touchscreen AM/FM Dash Radio with CD Player, Bluetooth®, Back-Up Monitor & Mirror Display
- Heated/Remote Exterior Mirrors with Integrated Side View Cameras
- Reclining/Swivel Leatherette Captain's Chairs with Stow-Away Coffee Table
- Emergency Engine Start Switch
- Cruise Control
- Tilt Steering Wheel
- Fog Lights
- Power Privacy Shade on Windshield
- 16" Tires with Stainless Steel Wheel Liners
- Valve Stem Extenders on Rear Wheels
- Dash Workstation with 110-volt & 12-volt Outlets



**IMPORTANT—PLEASE READ:** This brochure reflects product design, fabrication, material, components and specifications at the date of printing, which date is disclosed below. **Please visit us online at [ThorMotorCoach.com](http://ThorMotorCoach.com) or consult with your selling dealership for the latest in standards, options, specification and technical information.** Photographs in the brochure may depict optional equipment or may only be available in certain floor plans. Components, appliances and the chassis may have been manufactured in a calendar year before the vehicle's designated model year. All capacities are approximate. The actual length of the vehicle may differ from that indicated in the brochure due to variances in the manufacturing processes and/or installed components. All dry weights are based on standard model features and do not include optional features or equipment. Component part and appliance manufacturers issue limited warranties covering portions of the vehicle not covered under the limited warranty we issue. Copyright Thor Motor Coach, Inc. © OH 10/01/16

## INTERIOR

- Rubber Tread Entry Steps with Lighted Step Well
- Metal Entry Grab Handle
- Residential Vinyl Flooring Throughout
- 82" Interior Ceiling Height
- LED Lighting
- Ceiling Ducted Air Conditioning System
- Flat Panel Cabinet Doors with Rattan Inlay & Nickel Finish Hardware
- Full Extension Ball-Bearing Metal Drawer Guides
- Leatherette Sofa & Removable Pedestal Table (24.1 & 25.5)
- Leatherette Jack-Knife Sofa & Removable Pedestal Table (25.2)
- Dream Dinette® Booth (25.3 & 25.4)
- Window Privacy Shades
- 12-volt Attic Fan with Cover in Living Area

## KITCHEN

- 6 cu. ft. Double Door Refrigerator
- 3-Burner Gas Cooktop
- Convection Microwave Oven
- Pressed Laminate Countertops
- Oversized Sink with Single Handle Faucet & Pull-Down Sprayer
- Flip-Up Countertop Extension
- Pull-Out Pantry (25.2, 25.3 & 25.4)

## KITCHEN OPTION

- 3-Burner Gas Cooktop with Oven & Standard Microwave Oven

## BEDROOM & BATHROOM

- Two (2) Twin Beds with Upholstered Covers – Converts to King Size Bed (24.1 & 25.5)
- Queen Size Bed (25.2 & 25.3)
- Full Size Bed (25.4)
- Power Drop-Down Hide-Away Overhead Bunk with Cotton Cloud™ Mattress & Bunk Ladder
- Designer Headboard (24.1 & 25.3)
- Solid Surface Countertop (24.1 Bathroom Only)

- Foot Flush Porcelain Toilet
- Power Vent in Bathroom
- Shower with Curved Rod & Curtain

## BEDROOM & BATHROOM OPTION

- 12-volt Attic Fan with Cover in Bedroom

## ENTERTAINMENT

- 32" LED TV in Living Area
- 32" LED TV in Bedroom
- Exterior 32" LED TV on Manual Swivel
- DVD Ready on All TVs
- Bluetooth® Coach Radio System in Bedroom with Exterior Speakers
- Power Charging Center for Electronics
- TV Antenna & Booster
- Digital TV Antenna
- Cable TV Ready

## ELECTRICAL & PLUMBING

- Onan® RV QG 4000 Gas Generator
- 30-amp Detachable Shoreline Power Cord
- Automatic Shoreline-to-Generator Transfer Switch
- 13,500 BTU Roof Front Air Conditioner
- Battery Disconnect Switch
- Second Auxiliary House Battery
- Instant Tankless Water Heater
- Water Heater Bypass System
- Outside Shower
- Systems Control Center

## ELECTRICAL & PLUMBING OPTIONS

- 15,000 BTU Roof Front Air Conditioner
- Holding Tanks with Heat Pads

YOUR LOCAL THOR MOTOR COACH DEALER



**Made to fit.**

[thormotorcoach.com/axis](http://thormotorcoach.com/axis)



P.O. Box 1486, Elkhart, IN 46515 Sales Department: 800.860.5658 Customer Service: 877.855.2867